

REVISION HISTORY		
REV	DESCR./ECM #	DATE/INITIAL

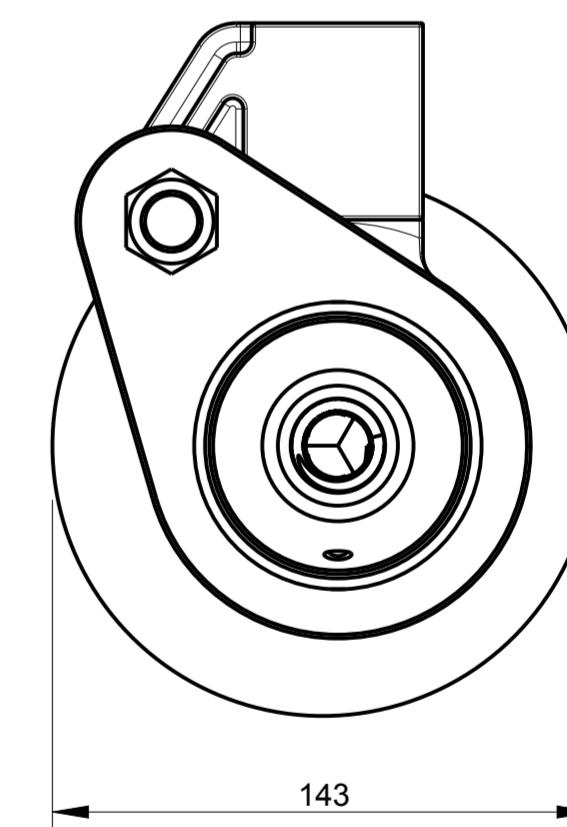

SCALE 1:8

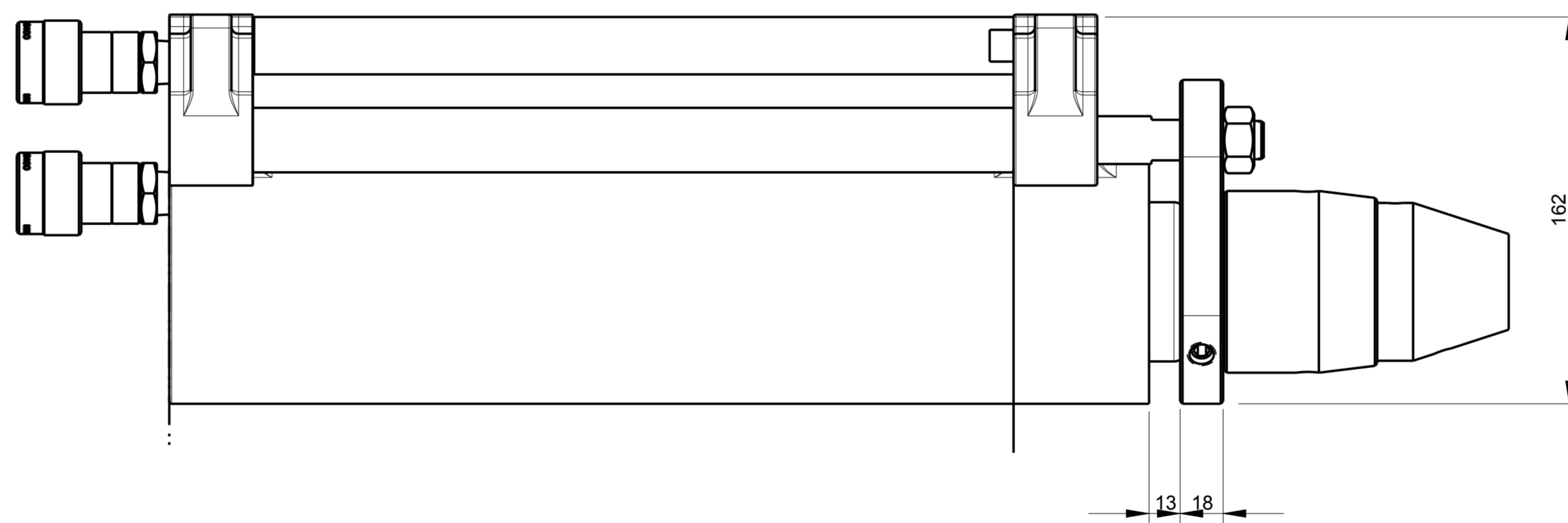
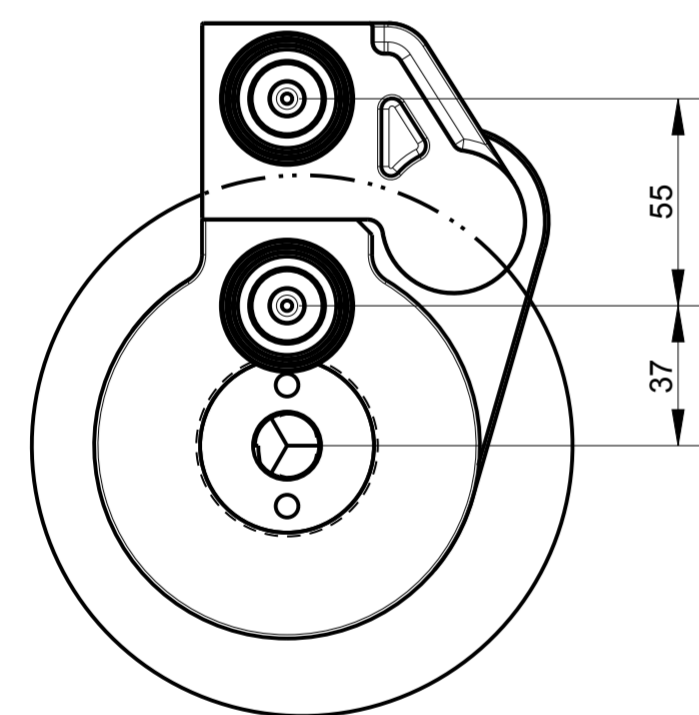
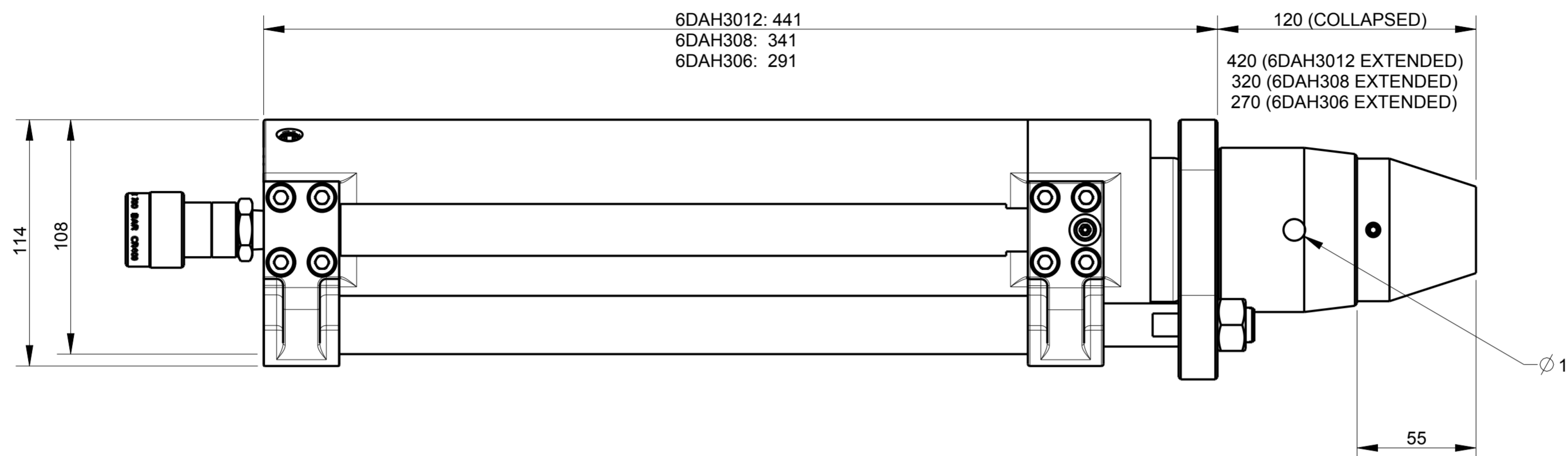

6DAH3012 WEIGHT: 27.8Kg
 6DAH308 WEIGHT: 21.8Kg
 6DAH306 WEIGHT: 20Kg

METRIC

THIRD ANGLE PROJECTION	UNLESS OTHERWISE SPECIFIED DIMENSIONS ARE METRIC TOLERANCES ARE:
	DECIMALS METRIC
FINISH UNLESS SPECIFIED	XX ±.01 X.X ±0.25mm
	XXX ±.005 X.XX ±0.1mm
	ANGLES ±1°
	DO NOT SCALE DRAWING
MATERIAL:	
FINISH:	
TREATMENT:	

DATE	02-Feb-15
DRAWN BY	RP
APPROVALS	DATE
CHECKER:	
ENGR:	RP 02/02/15
THIS PRINT AND INFORMATION HEREIN IS CONFIDENTIAL AND PROPRIETARY AND IS THE PROPERTY OF ENERPAC. IT IS NOT TO BE COPIED OR REPRODUCED WITHOUT WRITTEN PERMISSION.	

INFORMATION

ENERPAC			
TITLE 30TON HOLLOW JACK 6DAH3012 DIMENSIONAL DRAWING POST TENSION JACK			
SIZE	DWG NO.	PROD	
A2	RP51202001	B	
SCALE	DWG FORMAT	SHEET	
1:2	Pro/E	1of1	